

Keokuk County Iowa

Countywide G.P.S. Survey Control Network

Monument Site Pictures

2003

Dan Corbin, Inc.
28 River Ridge Lane
Cedar Falls, IA 50613



Cell: (319) 231-7047
Fax: (319) 266-3398
E-Mail: dcorbin@cfu.net

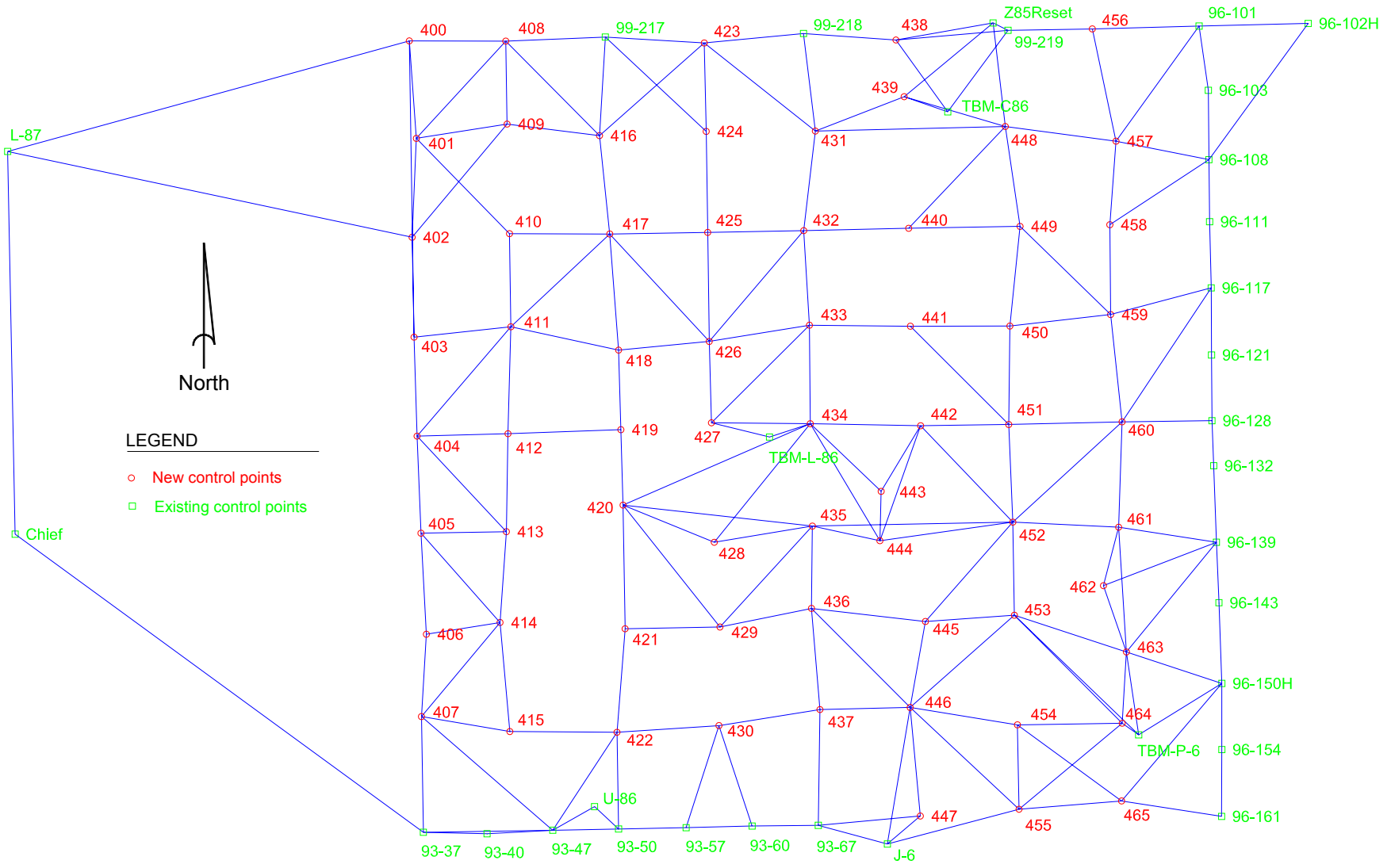

Keokuk County, Iowa

GPS Vector Network



#400 is 30ft north of 540th Ave, 50ft east of 190th St(190th St to the north-Poweshiek Co)
Near the NW corner of Sec 6 T77N, R13W.



#401 is 5ft south of north row fence, 10ft west of offset in row fence, 30ft north of cl 130th St, Approx. 0.3mi east of the west line of Sec 18.
In the SW ¼ of Sec 18 T77N, R13W.



402

LOOKING NORTH NW

#402 is 30ft north of 160th St, on section line to north & on cl of Zephyr to the south.
Near the SW corner of Sec 31 T 77N, R13W.



403

FACING EAST

#403 is 30ft south of 190th St, 30ft east of Zephyr Ave.
Near the NW corner of Sec 19 T76N, R13W.



#404 is 30ft west of ent to “Collision Repair Center”, 50ft south of Hwy. 92, approx. 200ft east of Zephyr Ave to north. Near the NW corner of Sec. 6, T75N, R13W.



#405 is 4ft south of the north ROW fence, 30ft north of 250th St, 0.1mi east of Zephyr Ave. 0.1mi east of the SW cor of Sec 18, T75N, R13W.



#406 is 5ft west of the east ROW fence, 15ft south of field ent.(to the east), 25ft east of Yates Ave, 0.1 mile south of 280th St. In the NW ¼ of Sec 6, T74N, R13W.



#407 is 3ft south of the north ROW fence, 30ft N of G65, approx. 200ft east of Yates Ave. Near the W1/4 corner of Sec. 18, T74N, R13W.



408

LOOKING WEST NW

#408 is 30ft west of the west edge of Hwy 21, approx 200ft south of 540th Ave.(Poweshiek Co.)
Near the NE corner of Sec. 4, T77N, R13W.



409

LOOKING WEST

#409 is 10ft east of the west ROW fence, 40ft west of the west edge of Hwy 21, in a dead fill, approx 0.4mi north of 130th St.
Near the E1/4 corner of Sec. 16 T77N, R13W.



410

LOOKING NORTHWEST

#410 is 5ft east of a power pole, 35ft west of the west edge of Hwy 21, approx. 300ft north of 160th St.
Near the SE corner of Sec 33, T77N, R13W.



411

LOOKING WEST

#411 is 45ft west of the west edge of Hwy 21, 1/4mi north of the SE corner of Sec 16.
1/4mi north of the SE corner of Sec 16, T76N, R13W.



412

LOOKING NORTH NE

#412 is 5ft south of the north ROW fence, 60ft north of the north edge of Hwy 92, 0.1mi west of the Hwy 92 & Hwy21 intersection.



413

LOOKING NORTHEAST

#413 is 25ft north of 250th St, 45ft west of a field ent to the north. Near the S1/4 of Sec 16, T75N, R13W.



#414 is 45ft northwest of 90 degree curve in 270th St, 12ft east of field ent to the north.
¼ mi north of the S ¼ of Sec 33, T75N, R13W.



#415 is 3ft south of the north ROW fence, on east edge of field ent to the north, 30ft north of 310th St, ¼ mi west of 130th Ave.
¼ mile west of the SE corner of Sec 16, T77N, R13W.



#416 is 4ft north of the south ROW fence, 30ft south of 130th St, 25ft west of vacated farmstead, ¼ mile west of 160th Ave.
¼ mile west of the NE corner of Sec 24, T77N, R13W.



#417 is 3ft south of the north ROW fence, 25ft west of field ent to the north, 25ft N of 160th St, 170ft east of 160th Ave.
Near the SW corner of Sec 31, T77N, R12W.



#418 is 30ft west of 163rd Ave, 60ft south of 195th St.
In the SW ¼ of Sec 19, T76N, R12W.



#419 is 5ft east of ROW marker, 30ft west of 163rd Ave, 30ft north of field
ent to the north, 0.1mi north of Hwy 92
In the SW ¼ of Sec 31, T76N, R12W.



420

LOOKING SOUTHWEST

#420 is 25ft south of 245th St, 5ft north of south ROW fence, 60ft east of 163rd Ave.

In the NW ¼ of Sec 18, T75N, R12W.



421

LOOKING SOUTH

#421 is 25ft south of 280th St, 25ft east of 162nd Ave.

In the NW ¼ of Sec 6, T74N, R12W.



#422 is 25ft west of 160 Ave, 0.1mi south of the NE corner of Sec 24.
0.1mi south of the NE corner of Sec 24, T74N, R13W.



#423 is 3ft east of the west ROW fence, 50ft south of 103rd St, 50ft west of 190th St.
In the NE ¼ of Sec 4, T77N, R12W.



424

LOOKING NORTH NE

#424 is 15ft east of the east edge of V44, 45ft south of the south end of bridge deck (South Fork).
Near the SW ¼ of Sec 15, T77N, R12W.



425

LOOKING SOUTH

#425 is 25ft south of 160th St, 30ft west of 190th Ave, at tee intersection.
Near the NE corner of Sec 4, T76N, R12W.



426

LOOKING NORTHWEST

#426 is 5ft east of west ROW fence, 25ft west of 190th Ave, approx. 400ft south of 193rd St.
In the NE ¼ of Sec 21, T76N, R12W.



427

LOOKING NORTH NW

#427 is 25ft west of 190th Ave, 100ft south of 185th St.
In the SE ¼ of Sec 33, T76N, R12W.



#428 is 25ft east of 190 Ave, approx. 300ft south of 255th St(to the east)
In NW ¼ of Sec 22, T75N, R12W.



#429 is 6ft north of south ROW fence, 10ft east of field ent to south, 25ft
south of 280th St, 0.1mi east of the NW corner of Sec 3.
0.1mi east of the NW corner of Sec 3, T74N, R12W.



430

LOOKING SOUTH

#430 is 3ft north of south ROW fence, 30ft south of 310th St, 25ft west of power pole, 200ft east of 190th Ave.
Near the NW corner of Sec 22 T74N, R12W.



431

LOOKING SOUTHEAST

#431 is 25ft east of 225th St, 70ft north of section line.
In the SW ¼ of Sec 18, T77N, R11W.



432

LOOKING SOUTH

#432 is 35ft south of 160th St, 85ft east of drive to south, 0.1mi west of the section line.

0.1mi west of the NE corner of Sec 1, T76N, R12W.



433

LOOKING EAST SE

#433 is 5ft west of the east ROW fence, 45ft north of the cl of field ent to the east, 75ft east of the east edge of Hwy 149.

Near the SW corner of Sec 18, T76N, R11W.



#434 is 55ft west of the west edge of Hwy 149, 55ft south of field ent to the west, approx. 600ft north of Hwy 92.
Approx. 600ft north of the SE corner of Sec 36, T76N, R12W.



#435 is 3ft east of west ROW fence, 15ft north of the section line, 30ft west of 220th Ave.
Near the SE corner of Sec 13, T75N, R12W.



#436 is 3ft south of power pole, 45ft east of field ent to the north, 30ft north of 275th St, 0.1mi west of 220th Ave.
In the NE ¼ of Sec 36, T75N, R12W.



#437 is 3ft south of north ROW fence, 30ft north of 305th St, 0.1mi east of section corner.
In the NW ¼ of Sec 18, T74N, R11W.



438

LOOKING WEST

#438 is 20ft west of 247th Ave, 20ft north of field ent to west, 0.2mi south of county line.
In the NE ¼ of Sec 4, T77N, R11W.



439

LOOKING SOUTH SE

#439 is 25ft south of 120th St, 25ft west of field ent to south, approx. 200ft west of section line.
Near the NE corner of Sec 16, T77N, R11W.



#440 is 25ft north of 160th St, 50ft southwest of curve in 250th Ave.
Near the SE corner of Sec 33, T77N, R11W.



#441 is 30ft east of 250th Ave, 18ft north of cl of field ent to the east.
Near the SW corner of Sec 15, T76N, R11W.



442

LOOKING NORTH NE

#442 is 5ft south of north ROW fence, on high bank of back slope, 1/4mi east of section line.
In the SW ¼ of Sec 34, T76N, R11W.



443

LOOKING SOUTHWEST

#443 is 5ft north of south ROW fence, 55ft east of farm lane to the south, 30ft south of 240th St, approx. 300ft east of 240th Ave(to the north).
Near the NW cor of Sec 16, T75N, R11W.



#444 is 5ft south of north ROW fence, 20ft west of field ent to the north, 45ft NE of curve(255th St to west, 240th Ave to south). Near the E ¼ corner of Sec 20, T75N, R11W.



#445 is 45ft southwest of curve in V5G, 50ft south of 253rd Ave. In the NW ¼ of Sec 3, T74N, R11W



#446 is 3ft west of east ROW fence, 15ft north of field ent to the east, 30ft east of 248th Ave, 60ft north of 305th St
In the NE ¼ of Sec 16, T74N, R11W.



#447 is 6ft south of power pole, 30ft east of 250th Ave, 0.2mi north of county line.
In the SW ¼ of Sec 34, T74N, R11W.



#448 is 25ft north of field ent to the east, 25ft east of 280th Ave, approx 150ft south of section line.
Near the NW corner of Sec19, T77N, R10W.



#449 is 25ft south of 160th St, 60ft east of field ent to the south, ¼ mi east of 280th Ave.
In the NW ¼ of Sec 6, T76N, R10W.



450

LOOKING SOUTH

#450 is 30ft south of 190th St, 80ft east of 280th Ave.
Near the NW corner of Sec 19, T76N, R10W.



451

LOOKING NORTH NE

#451 is 35ft north of the north edge of Hwy 92, approx. 300ft west of
V67(280th Ave.)
Near the SE corner of Sec 36, T76N, R11W.



#452 is 5ft east of the west ROW fence, 50ft west of the east edge of V67, 60ft north of 250th St.
Near the SE corner of Sec 13, T75N, R11W.



#453 is approx. 200ft west of V67 on top of high bank of back slope, 0.1mi north of 280th St.
In the SE ¼ of Sec 36, T75N, R11W.



#454 is 4ft west of east ROW fence, 25ft south of entrance to “Church of the Brethern Cemetery”, 50ft east of 280th Ave, approx. 500ft south of section line.
In the NW ¼ of Sec 19, T74N, R10W.



#455 is 4ft west of east ROW fence, 25ft north of field ent to the east, 20ft east of 280th Ave, 0.1mi south of 335th St.
In the SW ¼ of Sec 31, T74N, R10W.



#456 is 5ft north of power pole, 30ft east of 305th Ave, 25ft south of Keokuk/Iowa Rd.
In the NE ¼ of Sec 4, T77N, R10W.



#457 is 5ft south of north ROW fence, 40ft north of north edge of Hwy 22, approx. 300ft west of 312th Ave.
In the SW ¼ of Sec 22, T77N, R10W.



#458 is 4ft east of the west ROW fence, 50ft south of 160th St, 50ft west of 310th Ave.
Near the NE corner of Sec 4, T76N, R10W.



#459 is 3ft east of the west ROW fence, 25ft north of a field ent to the west, 30ft west of 310th Ave, ¼ mi north of 190th St.
In the SE ¼ of Sec 16, T76N, R10W.



#460 is 5ft south of the north ROW fence, 25ft west of a field ent to the north, 60ft north of Hwy 92, 0.2mi east of 310th Ave.
In the SW ¼ of Sec 34, T76N, R10W.



#461 is 5ft west of east ROW fence, 10ft north of field ent to the east, 30ft east of 310th Ave, 55ft north of 253rd St to the east.
In the NW ¼ of Sec 22, T75N, R10W.



#462 is 20ft north of wood plank bridge over ditch, on an extension of 268th St to the west, 33ft west of 305th Ave.
Near the S ¼ corner of Sec 28, T75N, R10W.



#463 is 3ft north of south ROW fence, 15ft west of field ent to the south, 30ft south of 290th St, 0.2mi east of 310th Ave.
In the NW ¼ of Sec 10, T74N, R10W.



#464 is 5ft west of east ROW fence, 30ft south of field ent to the east, 30ft east of 310th Ave, 150ft south of 310th St. In the NW ¼ of Sec 22, T74N, R10W.



#465 is 30ft north of 335th St, near the E ¼ cor of Sec 33. Near the E ¼ corner of Sec 33, T74N, R10W.



93-37

LOOKING EAST SE

Found Wapello Co GPS point 93-37 on 4-16-03



93-40

LOOKING SOUTHEAST

Found Wapello Co GPS point 93-40 on 4-16-03



93-47

LOOKING SOUTH

Found Wapello Co GPS point 93-47 on 4-16-03



99-217

LOOKING EAST

Found Iowa County GPS point 99-217 on 4-17-03



Found Iowa County GPS point 99-218 on 4-17-03



Found Iowa County GPS point 99-219 on 4-18-03